

RECEIVED AND PROCESSED
BY LAND DEVELOPMENT
INITIALS *[Signature]*
APR 05 2017

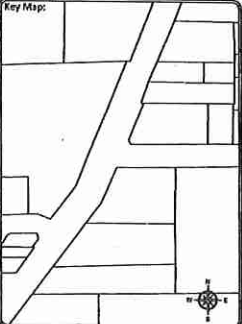

Sheet Title:
Design
Function: Make ready Task: FDH Placement



- NOTES:**
- 600 INSTALL 432F FDH ON CONCRETE PAD WITH 2x BOLLARS. SEE DETAIL 'C' SHEET 600
 - 601 STUB 2-100mm DUCTS 0.6m ABOVE FINISHED GRADE
 - 602 INSTALL (2) 100mm DBII PVC CONDUIT L= 6.0 m. SEE DETAIL 'B' SHEET 600
 - 603 CORE FOR 2-100mm CONDUIT IN TELUS MH-192 SEE DETAIL 'A' SHEET 600
 - 604 NEW 90° BEND 2-100mm DBII PVC CONDUIT

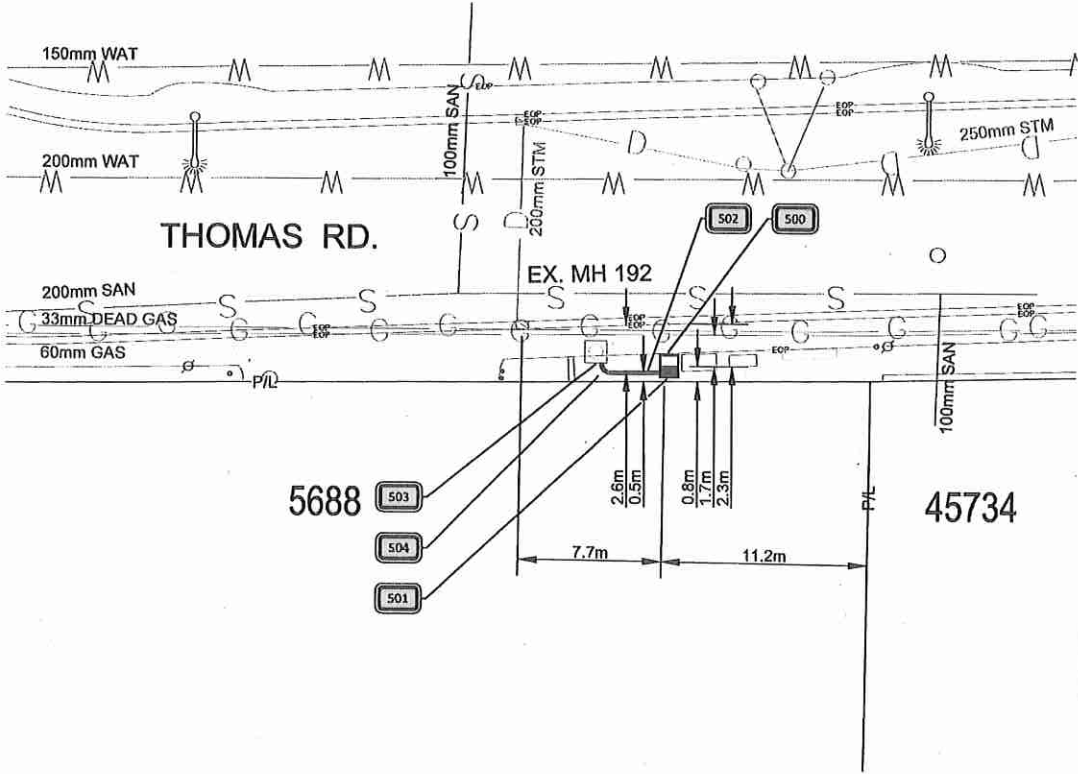

5688

45734

PLAN VIEW

HORIZONTAL SCALE: 1 : 250

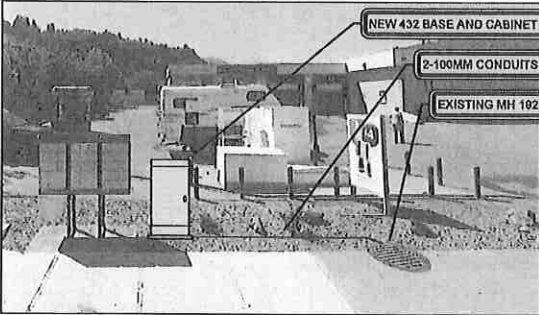

5688 THOMAS ROAD
FDH - SITE PLAN

N.T.S.

CAUTION:
GAS FACILITIES IN AREA
LOCATE AND EXPOSE
PRIOR TO COMMENCING WORK

METHOD OF PLACEMENT
VIA OPEN TRENCH UNLESS
OTHERWISE NOTED

LOCATE AND PROTECT ALL
OTHER UTILITIES IN FIELD

ALL MEASUREMENTS ARE IN
METERS UNLESS NOTED



Client: **TELUS**

Prepared By: **F A F L**
SUITE 200 - 7485 130 ST
Surrey BC V3W 1H8

Rev	Date	Notes	QC
-	-	-	-
-	-	-	-
-	-	-	-
-	-	-	-

IFP: MARCH 20TH 2017
DRAWN BY: IFC: MARCH 2017
DESIGNED BY: KADTEC SYSTEMS

Proprietary Information
Not for disclosure except under written agreement



Project: **Falcon 2017**
SRDS 3083A - 2629199
Sardis, BC

File Name:
COID: SRDS Route: 3083A
Network Number: 2629199 Sheet Number: 600

Date: May 11, 2017 Author: Kat McCawley 604-444-3732 ext 247, 604-366-8857 Project: SRDS 3083A - 2629199
 Universal Flagging: 170-8061 Loughheed Hwy Burnaby, BC V5A 1W9 Office: 604-444-3732 Dwg: 001

Comments:

AFL Global/ Telus
 Kelly Buchanan: 250-465-7330

City of Chilliwack

Job location: Thomas Road between Vedder Road and Village St

Closure description: Eastbound parking lane closure on Thomas Road

Tentative date and hours: May 29 - June 7, 2017

Job description: Civil Construction- New conduit and pad construction for Fibre Distribution Hub cabinet

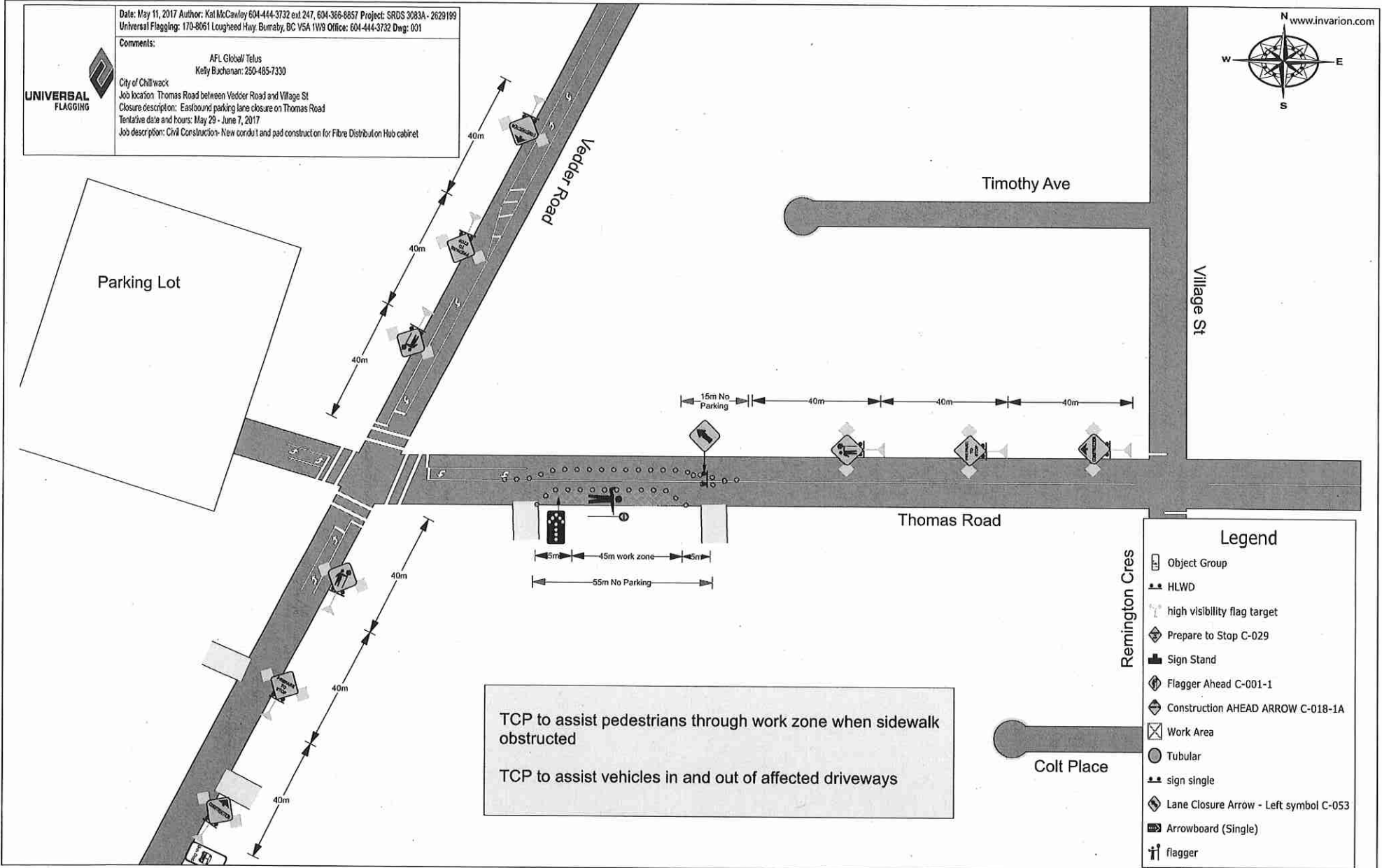

TCP to assist pedestrians through work zone when sidewalk obstructed
 TCP to assist vehicles in and out of affected driveways

- Legend**
- Object Group
 - HLWD
 - high visibility flag target
 - Prepare to Stop C-029
 - Sign Stand
 - Flagger Ahead C-001-1
 - Construction AHEAD ARROW C-018-1A
 - Work Area
 - Tubular
 - sign single
 - Lane Closure Arrow - Left symbol C-053
 - Arrowboard (Single)
 - flagger

Remington Cres

Colt Place